

GEMINI 1700

USER MANUAL



INTRODUCTION

COPYRIGHT

This user manual is supplied with the purchase of a bath and any optional equipment and is intended to provide information on its correct and safe use. Copying it for these purposes is only permitted if it is copied in its entirety to ensure all the pertinent health and safety related information along with the user information is retained together as a whole. Copying part of the manual for the purposes detailed above is not permitted under any circumstances © 2024.

Abacus Healthcare is part of **Gainsborough Healthcare Group Ltd.**, 10 & 11, The Oaks, Clews Rd, Redditch, England B98 7ST.



Contact: Abacus Healthcare on 01527 400024

PREFACE

Additional reading and related information can be obtained upon request, including Circuit Diagrams, Component Parts Lists, Descriptions, Calibration Instructions, and other information that will assist service personnel.

If an alternative format of this or any other documentation is required, please contact your authorised representative or **Gainsborough Healthcare Group Ltd.** on 01527 400022.

INTENDED USE

The bath is designed to be used for general hygiene purposes as well as relaxation. It must not be used for any other purpose.

This equipment is intended to facilitate the bathing of residents in care facilities or in a home care environment. The product is designed to help people who struggle with getting in and out of a bath, especially those with physical limitations.

With the bath already filled with water, the bather seats themselves on the platform, or is transferred onto the platform by the carer or via hoist equipment. Then operated by the bath handset, the motorised mechanism lifts the bath around the bather so that they are surrounded by the water. The carer can adjust the height to a level most suitable for them. This way, the bather can enjoy their bath comfortably and easily.

RECYCLING

The following materials are used in the packaging of the bath for transportation purposes. Separate the materials and dispose of them at a recycling centre in line with your local authority's recommendations.

- Wood
- Cardboard
- Plastics

FUTURE PRODUCT DEVELOPMENT

Gainsborough Healthcare Group Ltd operates a policy of continuous product development and reserves the right to change specifications and designs without prior notice.

TABLE OF CONTENTS

Introduction	2
Copyright	2
Preface	2
Intended Use	2
Recycling	3
Future Product Development	3
Bath and Equipment Overview	5
Specifications & Dimensions	9
Specifications	9
Dimensions	10
Safety Information	11
Purposes of Warnings, Cautions and Notes	12
Health and Safety Warnings	13
Health and Safety Cautions	14
Health and Safety Notes	15
Labels	16
Identification Label	17
User Information	18
Remote Handset	19
Backrest Install	19
Footrest Install (Option)	20
Close the Pop-Up Waste	20
Fill the Bath	21
Proximity Sensors	22
Transfer Bather into Bath	23
Topping Up the Bath	24
Adjust Bath Height	24
Remove Bather From the Bath	25
Empty and Clean the Bath	26
Raise the Platform	27
Lock the Platform	27
Lower the Platform	28
Optional Equipment	29
Shepherd's Crook Shower Option	29
Roaming Shower Option	30
Foot Rest Option	31
Autofill Option	31
Twin Lever Bath Filler Option	32
Schuchmann Basti Seat Option	32
Miscellaneous Options	33
Maintenance and Cleaning	34
Troubleshooting	37
Warranty	38
Declaration of Conformity	39

[illegible]

Key: Refer to Fig 0261

- 1 Platform bath
- 2 Backrest
- 3 Backrest cover slip-resistant
- 4 Remote handset
- 5 Pop-up waste
- 6 Platform
- 7 Bath panels
- 8 Shepherd's Crook shower system (Optional)
- 9 Autofill (Optional)
- 10 Twin lever bath filler (Optional)
- 11 Sound system compatible with smart phone and tablets (Optional)
- 12 Chromatherapy lighting (Optional)
- 13 Air spa and chromatherapy lighting (Optional)
- 14 Air spa (Optional)
- 15 Two meter shower hose (Optional)
- 16 Roaming shower system (Optional)

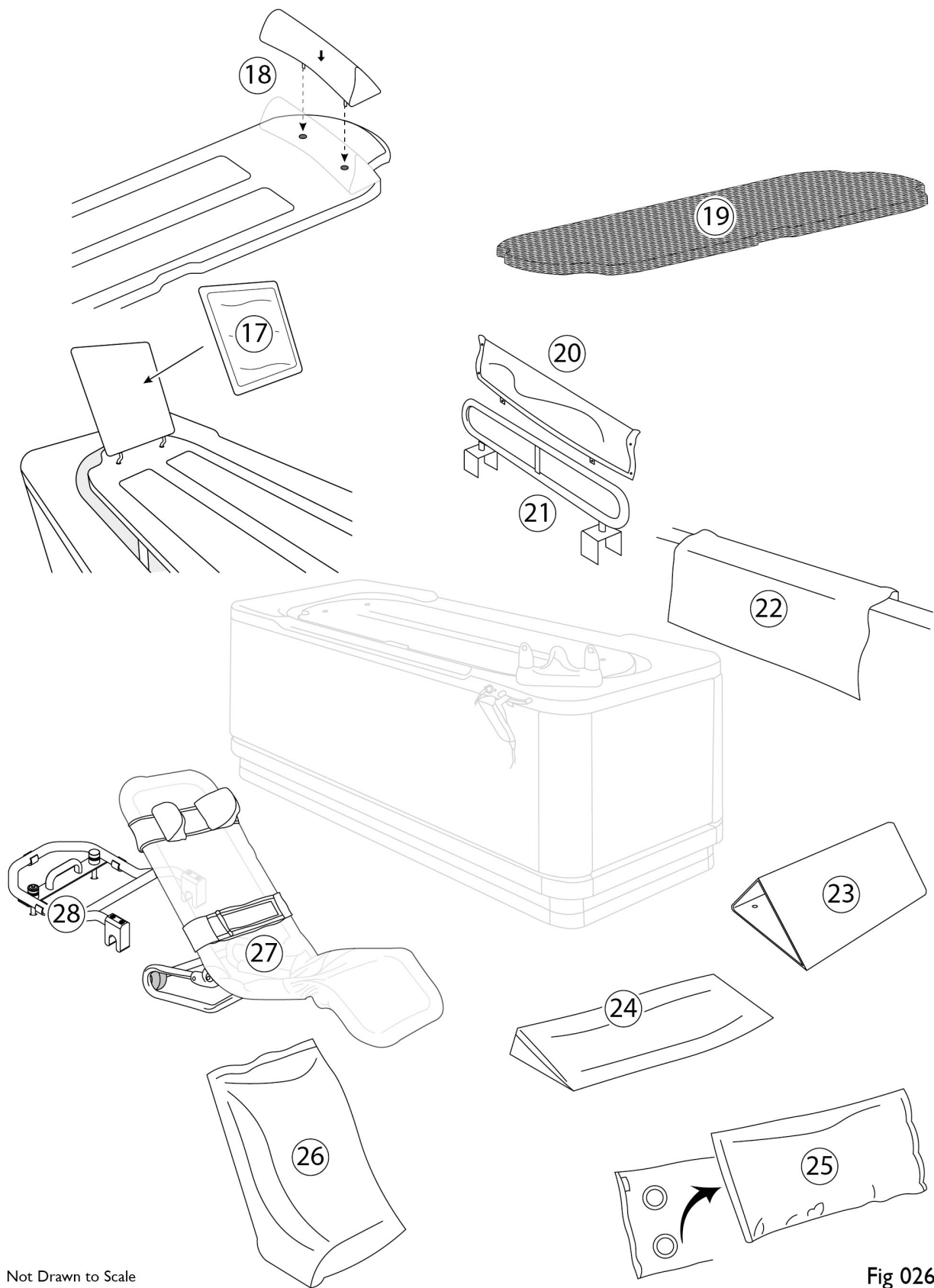

Not Drawn to Scale

Fig 0262

Key Refer to Fig 0262

- 17 Backrest cover padded (Optional)
- 18 Footrest (Optional)
- 19 Platform cover slip-resistant (Optional)
- 20 White vinyl padded grab rail cover (Optional)
- 21 Safety rail stainless steel (Optional)
- 22 Folding utility cushion vinyl padded with suckers (Optional)
- 23 Suckered knee break with padded knee break pad (Optional)
- 24 Head wedge cushion - vinyl padded (Optional)
- 25 Mesh multi-purpose cushion with suckers (Optional)
- 26 Back rest wedge cushion - vinyl padded (Optional)
- 27 'Schuchmann Basti Seat' (Optional) use in conjunction with a 'Basti Seat Fixing Bracket' (28)
- 28 'Basti Seat Fixing Bracket' (Optional) use in conjunction with a 'Schuchmann Basti Seat' (27)

SPECIFICATIONS & DIMENSIONS

SPECIFICATIONS

Maximum user weight: 150kg

Water Capacity: 220ltr

Approximate Bath weight (empty): 200kg

Approximate Bath weight (filled): 420kg

Bath raise (first/second): 35secs/33secs

Bath down (first/second): 37secs/38secs

Class I Electrical Device

Power Supply: Mains 230V to be supplied via 30mA RCD

Operating Voltage: 24V

Battery Backup: 24V for emergency use only

Water Supply: Unblended Hot & Cold water at 1bar Min > 5bar Max pressure

'A' weighted sound emission: <70dB(A)

'A' weighted sound emission with air spa system (optional extra): <75dB(A)

Ambient temperature range: 5°C to 50°C

Relative humidity range: 10-80%

Atmospheric pressure range: 50kPa to 106kPa

This bath has BioCote® technology, this has been proven to reduce bacteria and even some viruses, including influenza A H1N1, *E.coli*, *Salmonella* and MRSA



DIMENSIONS

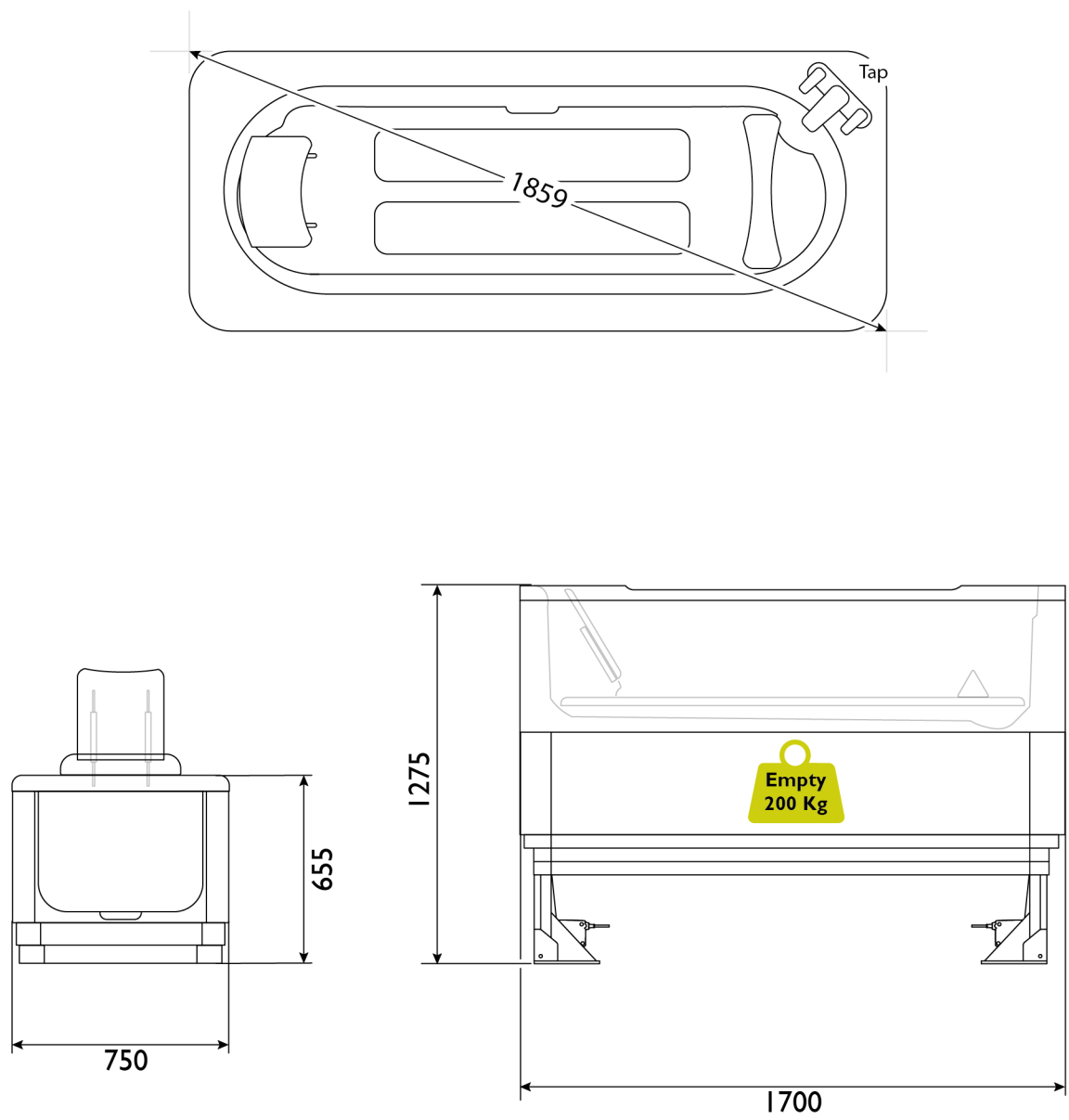

Fig 0205

Refer to Fig 0205, dimensions in millimetres (mm). Left hand example (handing of a bath is indicated by the exit point of the bath when in a seated position).

SAFETY INFORMATION

**WARNING RISK OF ELECTROCUTION/FIRE/ENTRAPMENT:**

Modifying the bath/equipment could cause serious injury or prove fatal. Under **NO CIRCUMSTANCES** should you modify the bath/equipment.

Your bath, supplied by the **Gainsborough Healthcare Group Ltd.**, is part of a range of products designed and built for bathers in care homes, hospitals and other specialist care environments.

Please ensure that you read and thoroughly understand this user manual. This information is vital for the correct operation of the bath, ensuring the safety of both bather and operator at all times.

Please use this bath in the manner specified in this manual. **Gainsborough Healthcare Group Ltd.** do not take any liability if the product is misused.

To ensure best practice and safety the bath must be operated only by a trained person with adequate understanding of the specific environment, its common practices and processes. It is vital that regular assessments of the bather are undertaken to ensure the bath remains suitable. **Gainsborough Healthcare Group Ltd.** does not take responsibility for individual product suitability.

Depending on configuration, your bath may have sensory features installed. These are for the enjoyment and relaxation of the bather. To ensure these features are used appropriately, the bather's condition must be assessed prior to operation.

Accessories and any detachable parts must be used as described in this user manual and must not be modified or used with other equipment not specified in this user manual.

This bath is for hygiene and relaxation purposes only. **DO NOT** use for any other purpose.

To avoid entrapment, make sure that the path of movement is free from obstacles. Make sure the bather retains a comfortable and safe position. To avoid injury, do not leave the bather at any time. The bather must not be allowed to exit the bath whilst the bath is in the raised position. This could potentially cause serious injury to the bather and could also damage the product. **Gainsborough Healthcare Group Ltd.** does not take any liability if misused in this manner.

Any modifications to the bath or significant changes to its surrounding environment and installation may affect important safety and performance related functions. **Gainsborough Healthcare Group Ltd.** is not responsible for any safety incidents or functional performance issues arising as a result of any modifications that have not been approved in advance by **Gainsborough Healthcare Group Ltd.**



If you have any questions regarding the user manual or operation of the bath, feel free to contact your authorised representative or **Gainsborough Healthcare Group Ltd.** on 01527 400022.

PURPOSES OF WARNINGS, CAUTIONS AND NOTES

Warnings, Cautions and notes used throughout this manual have the following meanings:



WARNINGS: Warnings used throughout this manual **MUST** be followed carefully failure to do so, could result in serious bodily injury or could be fatal.



CAUTIONS: Cautions used throughout this manual **MUST** be observed to avoid damage to your bath or additional optional equipment.



NOTES: Notes used throughout this manual contain important information and useful tips on the operation of this product.

HEALTH AND SAFETY WARNINGS

The following warnings and any additional warnings used throughout this manual **MUST** be followed carefully failure to do so, could result in serious bodily injury or could be fatal.



WARNING RISK OF ENTRAPMENT: Operating the bath without appropriate training in its safe use could cause serious injury or be fatal by entrapment. Ensure persons operating the seat have been trained, read this manual & understand its safe use.



WARNING RISK OF ENTRAPMENT: Operating the bath when persons are nearby could cause serious injury or be fatal by entrapment. Ensure **NO** persons are close to moving equipment during its operation.



WARNING RISK OF ELECTRIC SHOCK: Using electrical appliances near to the bath could cause electric shock which may be fatal. **DO NOT** use electrical appliances within 3 metres of the bath.



WARNING RISK OF ELECTRIC SHOCK: Inappropriate wiring can cause an electric shock which may be fatal. Ensure the bath is installed by a qualified electrician using current legislation, the equipment must only be connected to a supply main with protective earth.



WARNING RISK OF ELECTRIC SHOCK: This product is powered with 240V AC. Only qualified electricians should work on this product in line with the current legislation. **ALWAYS** disconnect the power supply before removing any panels for maintenance and or repair.



WARNING RISK OF SLIPPING: Water left on the floor could cause serious injury or be fatal by slipping. Ensure the floor area around the bath is always free from water. Clean and dry **ANY** spillages immediately.

HEALTH AND SAFETY CAUTIONS

The following cautions and any additional cautions used throughout this manual **MUST** be observed to avoid damage to your bath or additional optional equipment.



CAUTION: Bath could be damaged which may be irreparable if objects/equipment is trapped during operation. Ensure there are no objects/equipment left under the bath or platform that can become trapped.



CAUTION: Remote handset could be damaged which may be irreparable. Ensure the remote handset is **ALWAYS** returned to its holder after use.



CAUTION: Bath/equipment could be damaged which may be irreparable. **NEVER** use the bath other than for its intended use.



CAUTION: Bath/equipment could be damaged which may be irreparable if using abrasive cleaners, bleach or scouring. Use cleaning methods outlines in the cleaning and maintenance section only.

HEALTH AND SAFETY NOTES

The following notes and any additional notes used throughout this manual contain important information and useful tips on the operation of this product.



NOTE: The system batteries must be charged for 24 hours prior to using the bath. You may test the bath seat operation empty to ensure it is working correctly.



NOTE: If this unit is to be utilised by many different bathers, we would strongly recommend that it is cleaned regularly with a medical disinfectant as well as following the strict cleaning routine outlined in the 'Maintenance and Cleaning' section.



NOTE: In the event of mains failure during use of the bath, back-up batteries will enable the bather to use the bath seat once. The bath seat will then be disabled until mains power is restored.



NOTE: If any serious incident occurs in relation to the device this should be reported to the manufacturer and the competent authority in which the user and/or patient is established.



NOTE: Expected lifetime of this product is 8 years, when adhering to our service and maintenance guidelines.

LABELS

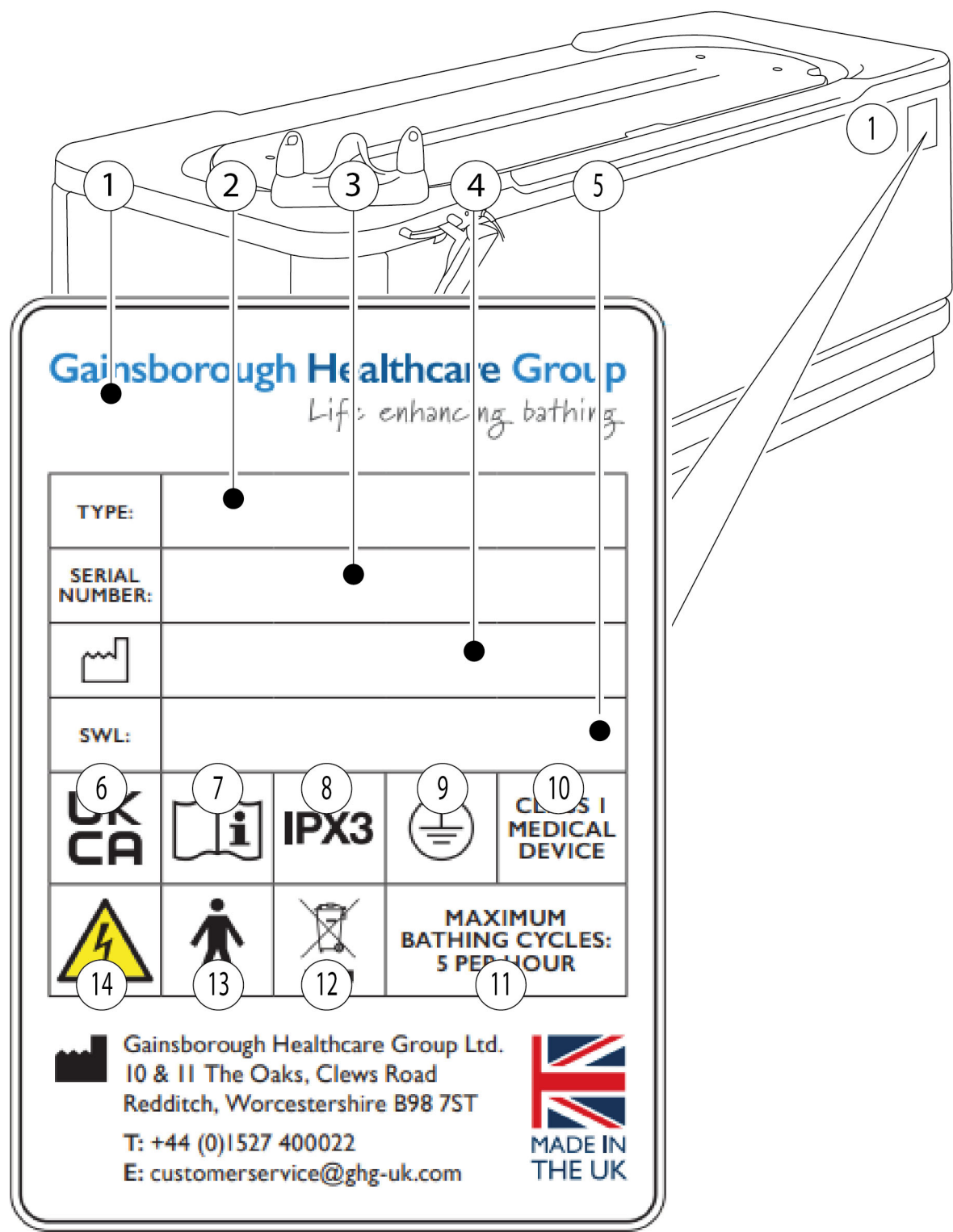

Fig 0258

IDENTIFICATION LABEL



NOTE: The 'Identification' label attached to your bath contains critical information! **DO NOT** remove it from its location. The serial number is required for maintenance, information or spare parts. It is recommended that you make a note of this below.

KEY (Refer to Fig 0258)

- 1 Identification label and its location
- 2 Type of bath this user manual refers to
- 3 Unique identification number (this is needed for maintenance, information or spares)

Make a note below Serial Number:

Serial Number:

- 4 Location where the bath was manufactured
- 5 The Safe Working Load
- 6 UK Conformity Assessed marking
- 7 Read instruction manuals and accompanying documents
- 8 Protection Class (This product is protected against spraying water)
- 9 Type of protection: Class I
- 10 Class I medical device
- 11 Maximum number of baths allowed per hour
- 12 No domestic waste. Separate electrical and electronic components for recycling in accordance with European Directive 2012/19/EU (WEEE)
- 13 Application part 'Type B' according to DIN EN 60601-1
- 14 This product is powered. Warning dangerous voltage

USER INFORMATION

The following steps are a pre-requisite before using the bath in **ANY** capacity.

1. Read the entire user manual.
2. Ensure you have received appropriate training in its safe and proper use for the bath and any additional optional equipment (this should be done following installation hand over).
3. Ensure the bath back up batteries have been fully charged for a minimum of 24 hrs prior to use.
4. Inspect the bath for any cracks or damage.
5. Test the bath and all safety devices/equipment (empty - without a bather) prior to its first use and periodically afterwards in line with the maintenance recommendations, see [maintenance and cleaning, page 34](#). Ensure it operates correctly as follows:
6. Operate the 'Bath up' function, ensure the bath rises to its maximum height, without excessive or unusual noises.
7. Operate the 'Bath down' function, ensure the bath lowers to the floor, without excessive or unusual noises.
8. Operate the 'Platform up' function, ensure the platform rises to its maximum height, without excessive or unusual noises.
9. Operate the 'Platform down' function, ensure the platform, lowers to its lowest position, without excessive or unusual noises.



Contact: If you are in any doubt or you cannot answer yes to **ALL**, the above steps then seek advice from your supervisor and or contact Gainsborough Healthcare Group Ltd: Tel: 01527 400024.

REMOTE HANDSET



CAUTION: If submerged in water, the remote handset could be damaged irreparably. Ensure the remote handset is **ALWAYS** returned to its holder after use.

Refer to Fig 0247, the 'Remote Handset' (1) comprises of four control buttons. To activate the operation, press the relevant button lightly and hold. Releasing the button/s at any time will stop the operation.

1. Remote Handset
2. Bath Up
3. Bath Down
4. Platform Up
5. Platform Down

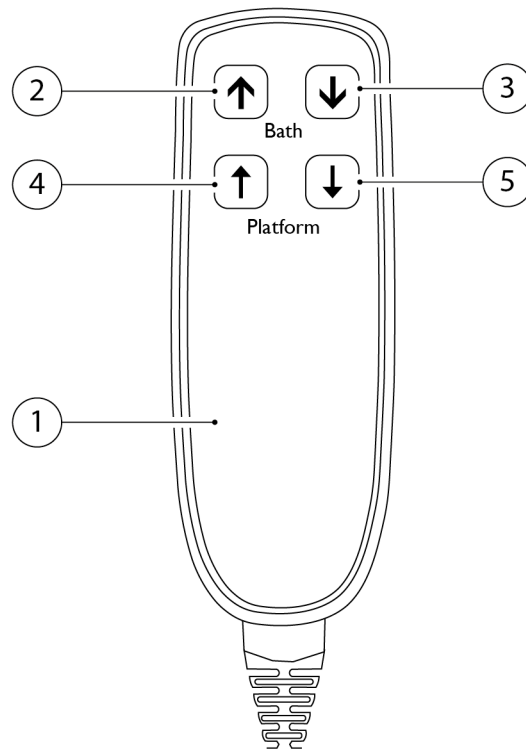

Fig 0247

BACKREST INSTALL

1. Refer to Fig 0245, install the back rest into the platform in the holes provided, the opposite end to the taps. This comes as standard with a slip-resistant cover.

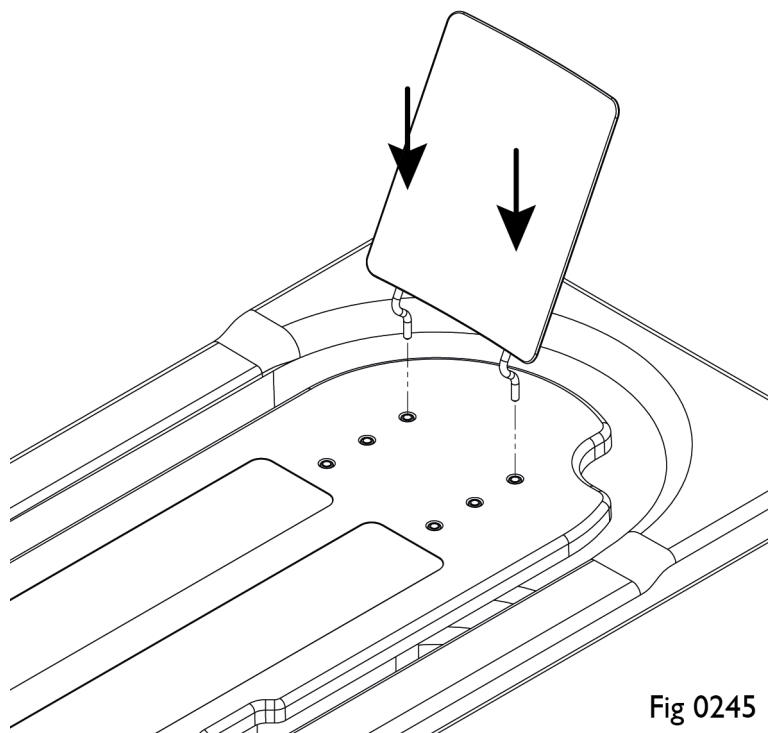

Fig 0245

FOOTREST INSTALL (OPTION)

1. Refer to Fig 0268, install the foot rest into the platform in the holes provided.

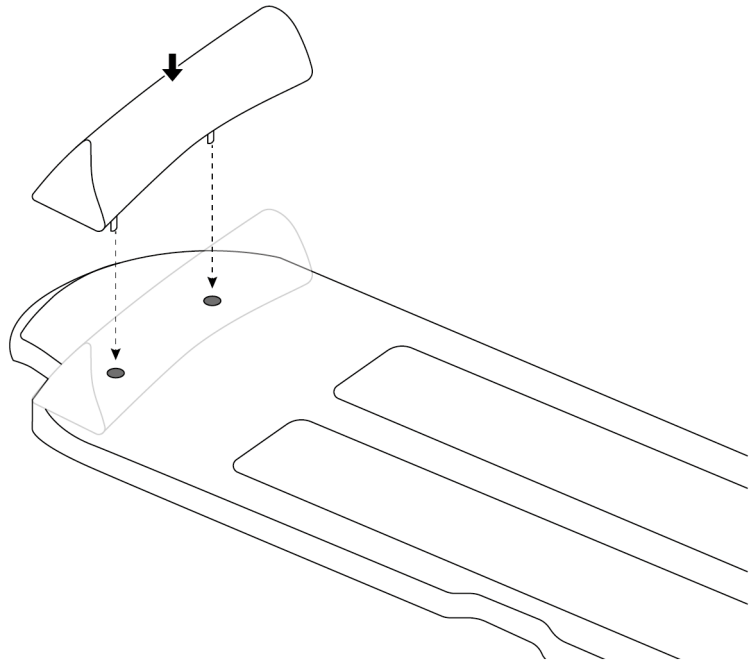

Fig 0268

CLOSE THE POP-UP WASTE

Your bath comes with a pop-up waste as standard.

1. Refer to Fig 0196, close the pop-up waste, turn the chrome handle (1) clockwise, the waste plug (2) closes.

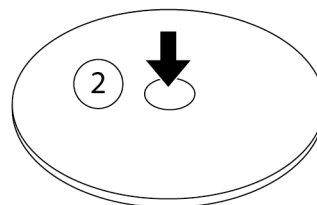
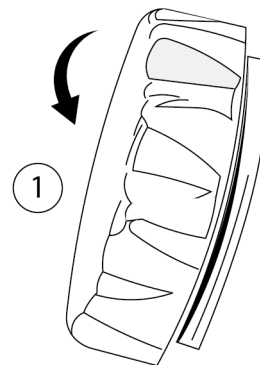

Fig 0196

FILL THE BATH



WARNING RISK OF SCALDING: Not checking the water temperature could cause serious injury or be fatal. The temperature of the hot water is limited to 43°C for safety. Use a thermometer to observe the temperature whilst filling and again before transferring the bather into the bath.

2. Refer to Fig 0264, depending on the options chosen you may have a 'Thermostatic twin lever bath filler' (1) see [twin lever bath filler option, page 32](#) for more information or an 'Autofill' option (2) see [autofill option, page 31](#) for more information, proceed as follows

3. Open the Hot tap (3) or press the Hot 'Autofill' button (3) and fill the bath to half full at the required temperature checking with a thermometer. Where necessary adjust the temperature using the Cold tap (4) or the 'Autofill' button (4). The bath is now ready for the bather. Topping up of the bath will be carried out when the bather is in position. This aids the carer to observe the depth of water.

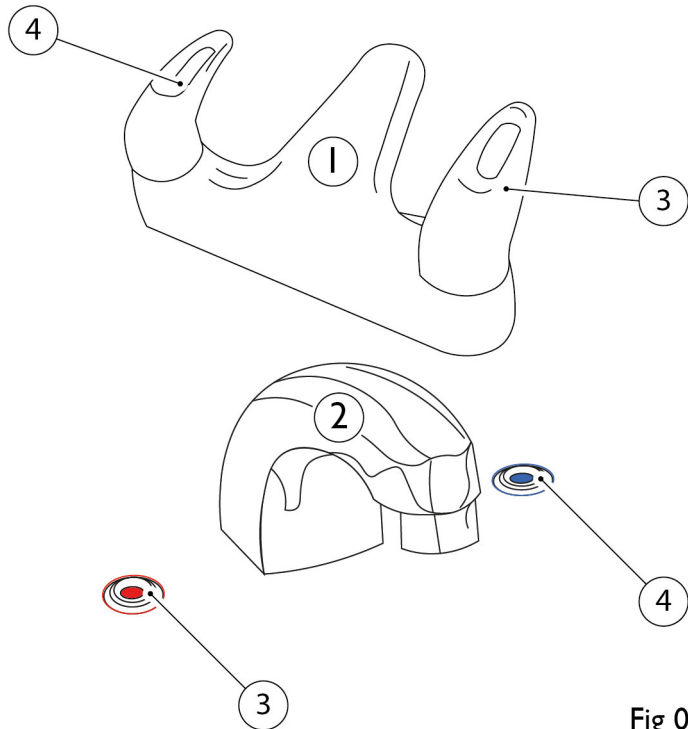

Fig 0264

PROXIMITY SENSORS



WARNING RISK OF ENTRAPMENT: Operating this bath/equipment when persons are nearby could cause serious injury or be fatal by entrapment. Ensure **NO** persons including the operator are close to moving bath/equipment during its operation.

4. The lower panel set is fitted with proximity sensors for added safety.
5. Whilst in use, if an obstruction is detected by upward pressure on the lower panels the sensors will activate, stopping any further movement.
6. In the event of sensor activation, release all remote handset buttons, remove obstruction, send the bath up then you can lower the bath/platform.

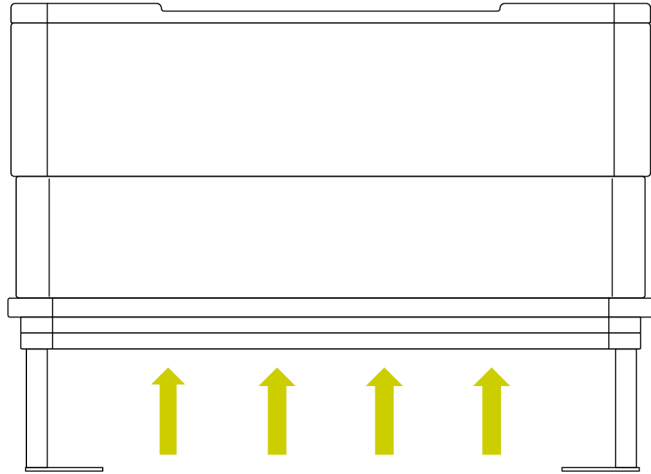

Fig 0269

TRANSFER BATHER INTO BATH



WARNING RISK OF ENTRAPMENT: Operating this bath/equipment when the bather is unsecured/unattended could cause serious injury or be fatal by entrapment. Ensure the bather is **NOT** left unattended and is seated properly at all times.

7. Refer to Fig 0265, allow/assist the bather to transfer onto the platform (a lateral transfer for an ambulant bather).



8. If a lateral transfer is not suitable use appropriate equipment to hoist or transfer the bather into position, refer to the relevant equipment user manual to transfer the bather onto the platform.

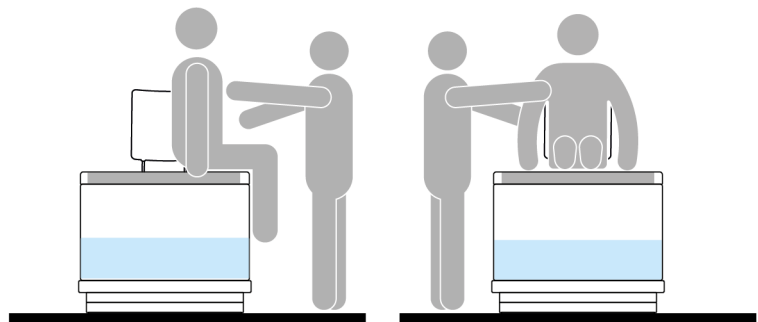

Fig 0265

9. Refer to Fig 0266, with the bather seated, raise the bath around the platform/bather, press and hold the 'Platform up' button (1). The bather will now be immersed in water.

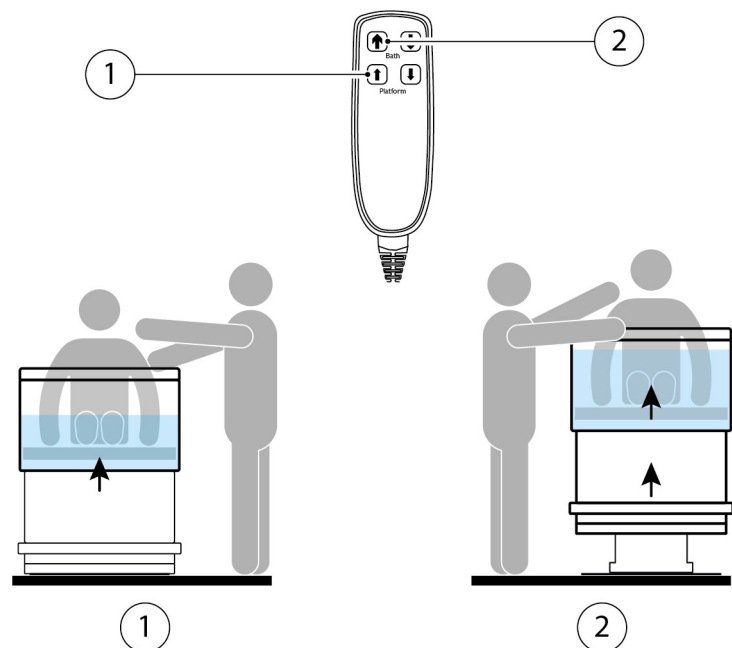

Fig 0266

TOPPING UP THE BATH

10. Refer to Fig 0264, depending on the options chosen you may have a 'Thermostatic twin lever bath filler' (1) see [twin lever bath filler option, page 32](#) for more information or an 'Autofill' option (2) see [autofill option, page 31](#) for more information, proceed as follows:

11. Open the Hot tap (3) or press the Hot 'Autofill' button (3) and top up the bath checking the temperature with a thermometer. Where necessary adjust the temperature using the Cold tap (4) or the 'Autofill' button (4).

ADJUST BATH HEIGHT

12. Refer to Fig 0266 (previous page), raise the bath and platform to the most comfortable height for the carer to provide assistance press and hold the 'Bath up' button (2).

For information on using the shower see [shepherd's crook shower option, page 29](#).

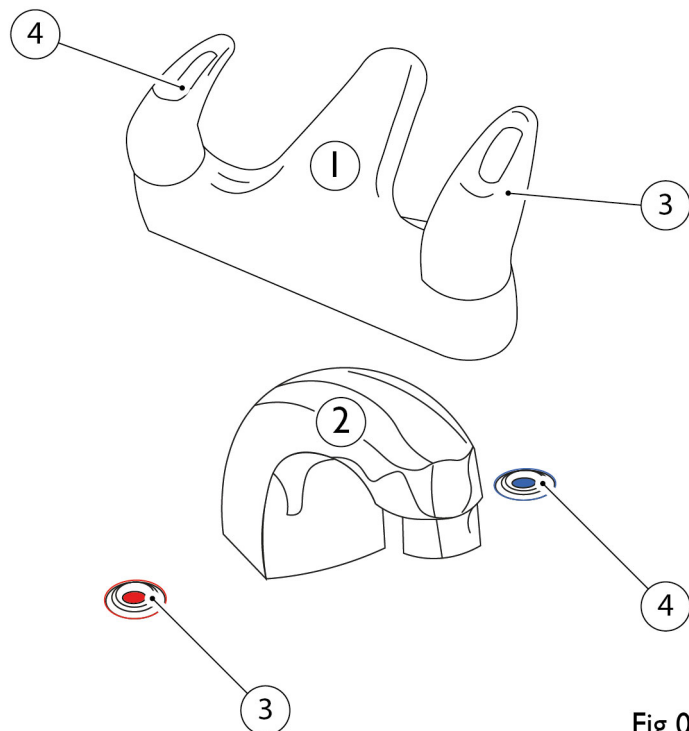

Fig 0264

REMOVE BATHER FROM THE BATH

13. When bathing is completed. Refer to Fig 0267, lower bath full of water, press and hold 'Platform down' button (1) to desired height.

14. Use the platform for drying/dressing prior to transfer.

15. Lower the bath, press and hold 'Bath down' button (2) in readiness for transferring the bather.

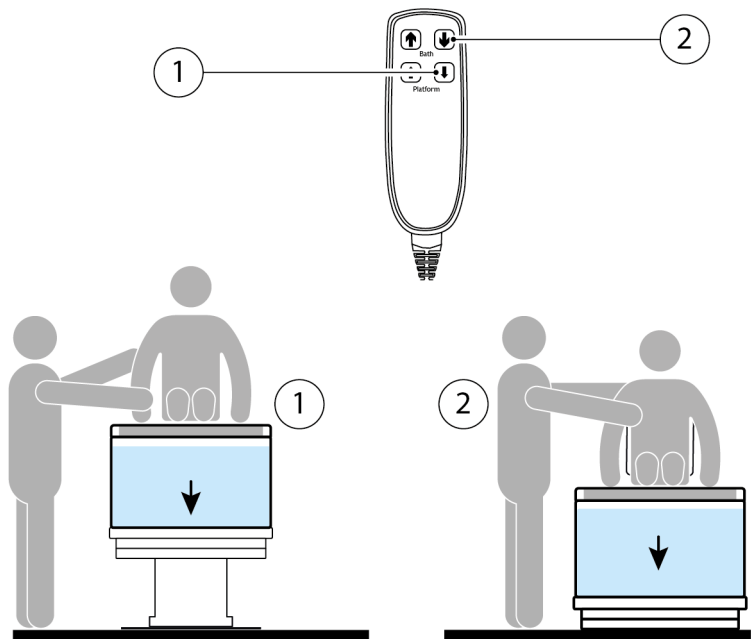

Fig 0267

16. Refer to Fig 0265, allow/assist the bather to transfer off the platform (a bed type transfer for an ambulant bather).

17. If the bather is not able and bather transfer is required, refer to the relevant equipment user manual to transfer the bather from the platform.

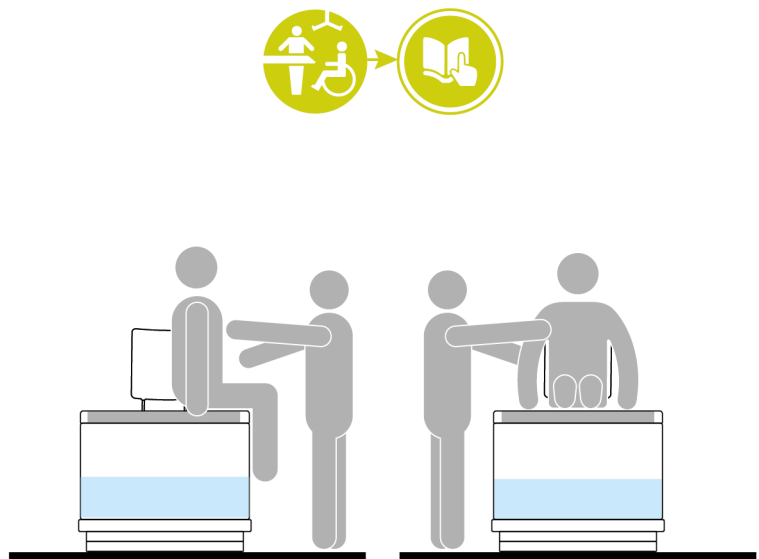

Fig 0265

EMPTY AND CLEAN THE BATH

Your bath comes with a pop-up waste as standard.

18. Refer to Fig 0263, open the pop-up waste, turn the chrome handle (1) anti clockwise, the waste plug (2) opens to drain the bath.

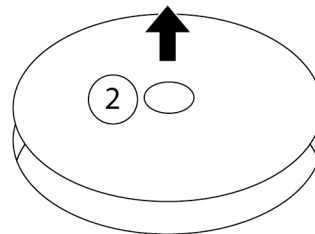
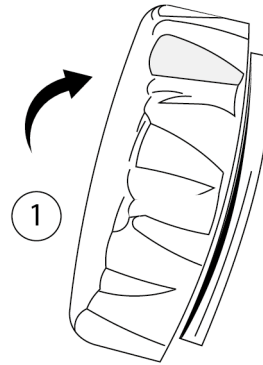

Fig 0263

19. Remove the 'Backrest' and 'Footrest' (option) from the platform and store in a safe place.

20. Thoroughly clean and disinfect the platform and bath see [maintenance and cleaning, page 34](#) for additional information.

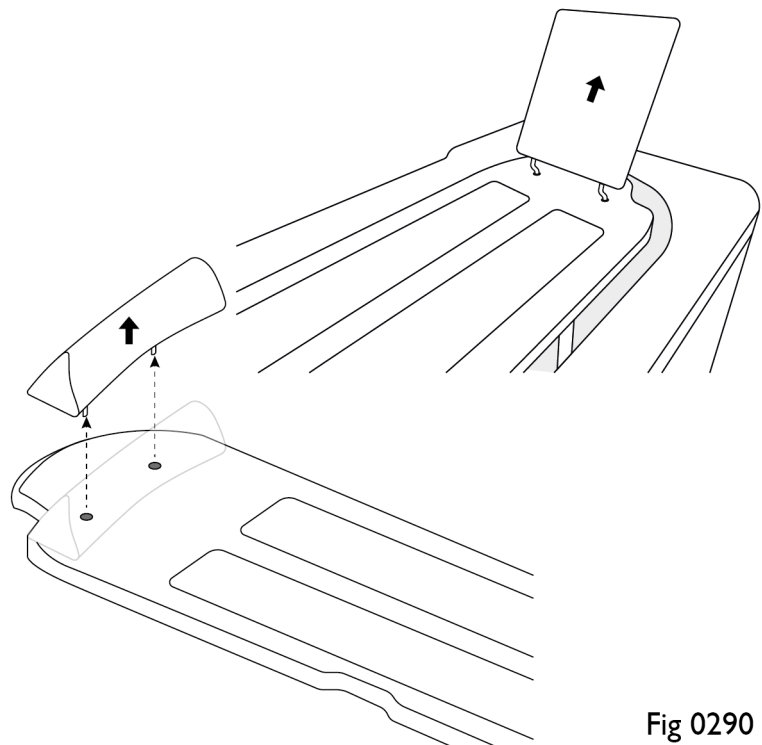

Fig 0290

RAISE THE PLATFORM



CAUTION: Platform backrest/footrest could become damaged which may be irreparable if left on the platform. Remove backrest and footrest before raising the platform.

21. Refer to Fig 0270, locate the safety lock plunger under the platform on the front left, when facing the bath.

22. Using your forefinger and middle finger pull the safety lock plunger (1) toward you, then raise the platform (2).

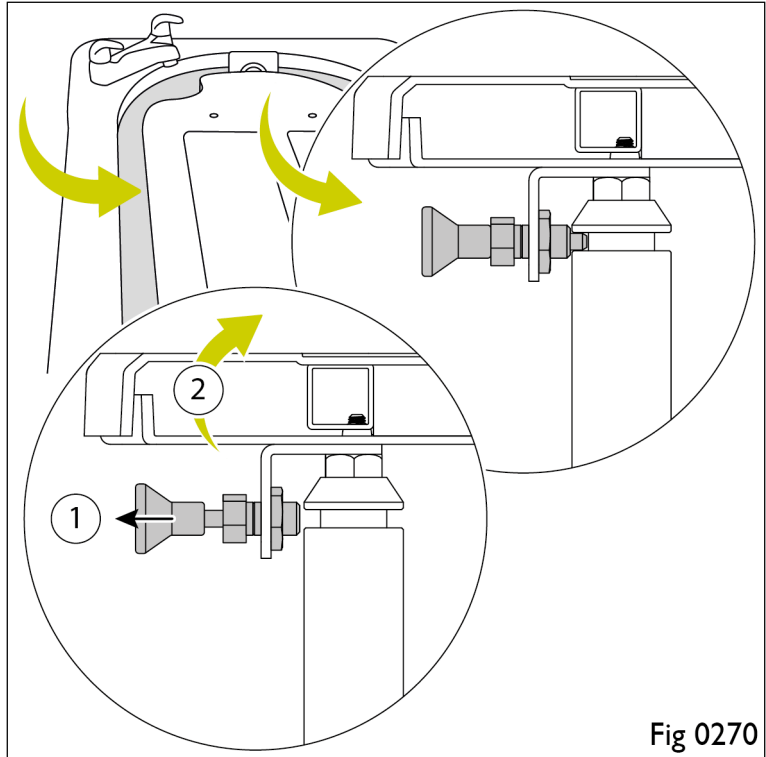

Fig 0270

LOCK THE PLATFORM

23. Raise the platform to its highest position which opens up the 'Hinge stay' to its full extent (1), then slightly lower the platform (2) to engage the 'Hinge stay' locking mechanism.

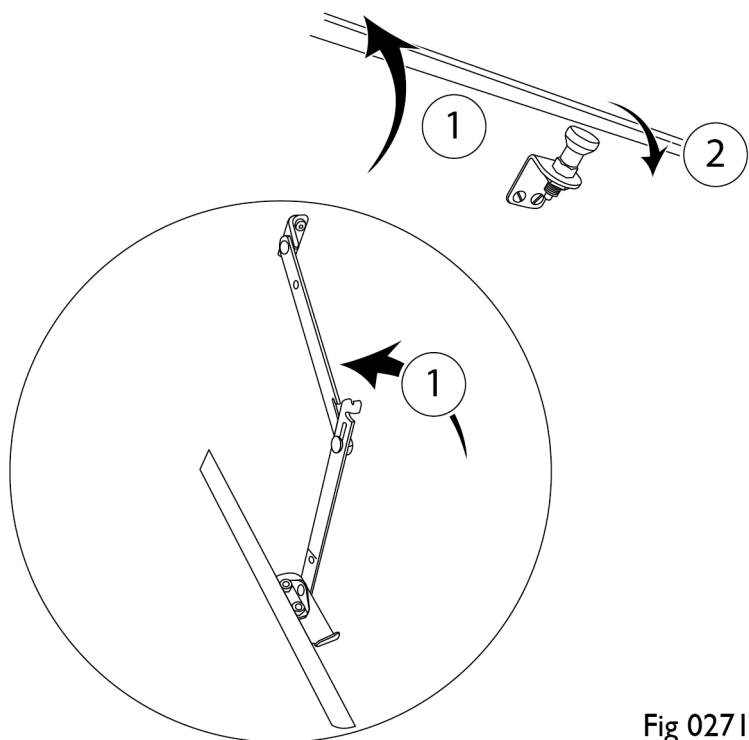

Fig 0271

LOWER THE PLATFORM

24. Refer to Fig 0272, slightly raise the platform and simultaneously bend the 'Hinge stay' (1) to disengage the lock.
25. Lower the platform and gently push with some downward pressure to engage the safety lock plunger (2).
26. Gently pull the platform upward (3) to ensure the safety lock plunger (2) is fully engaged.

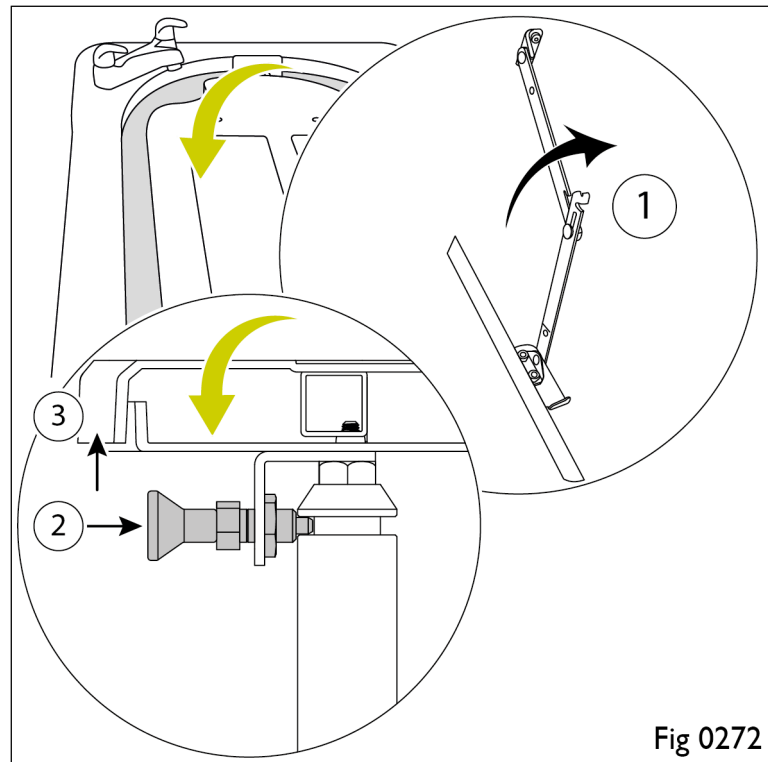

Fig 0272

OPTIONAL EQUIPMENT

For further information on the Air Spa, Chromatherapy Lighting or Sound System, please refer to the Accessories User Manual.

SHEPHERD'S CROOK SHOWER OPTION

1. Refer to Fig 0020, remove the shower head (1) from the holder, turn the shower control (2) anticlockwise fully. The temperature is controlled by a thermostatic valve and factory set at 38°C (Max) for safety.
2. With the shower head directed into the bath, press the trigger spray (3) on the shower head (1) to release the water. Check the temperature is safe with a thermometer and by hand. Release the trigger at any time to stop the water.
3. When showering is complete, turn shower control clockwise fully.
4. Press the trigger spray to depressurise the shower and return the shower head to the holder.

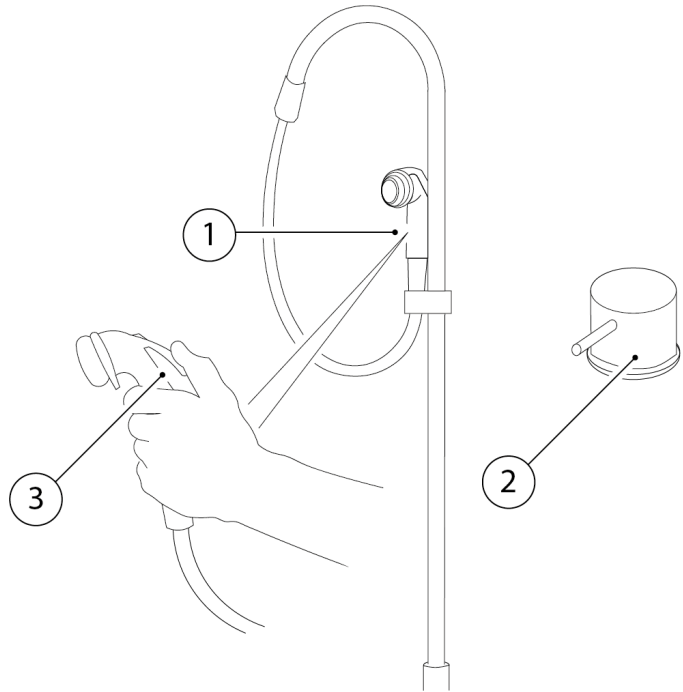

Fig 0020

ROAMING SHOWER OPTION

1. Referring to Fig 045I, remove the shower head (1) from the holder (2) and, directing the shower head into the bath, turn the temperature control dial (3) anticlockwise fully until it is at its maximum temperature (indicated on the dial in red). This is the optimum showering temperature, which is controlled by a thermostatic valve and factory set at 38°C for safety.

2. When showering is complete, turn the temperature control dial clockwise fully to its minimum temperature (indicated on the dial in blue) to stop the shower.

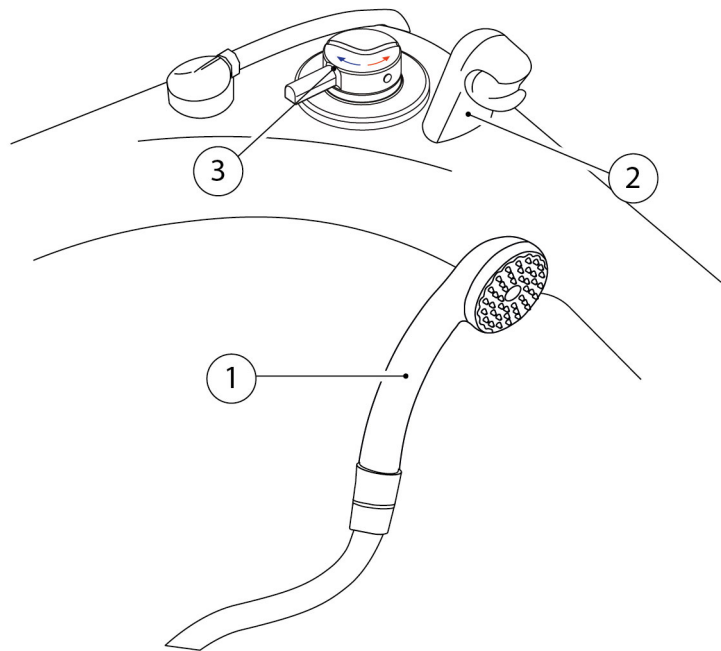

Fig 045I

FOOT REST OPTION

A footrest is available as an option. For more information see [footrest install \(option\), page 20](#).

AUTOFILL OPTION



NOTE: The auto-fill buttons glow red (hot) and cold (blue) constantly until pressed and will flash during filling.



NOTE: The auto-fill option has a pre-set temperature of 43° degrees Celsius.

The 'Autofill' option allows the bath to be filled with the press of a button using the following procedure:

Hot Water

1. Refer to Fig 0015, the 'Autofill' option has a spout (1). Press the hot (red) button (2) once. The water flow can be stopped at any time by pressing the button again.
2. To add more hot water, press the hot (red) (2) button again. Do not leave the bath unattended if the button is pressed a second time. Check the water temperature with a thermometer.

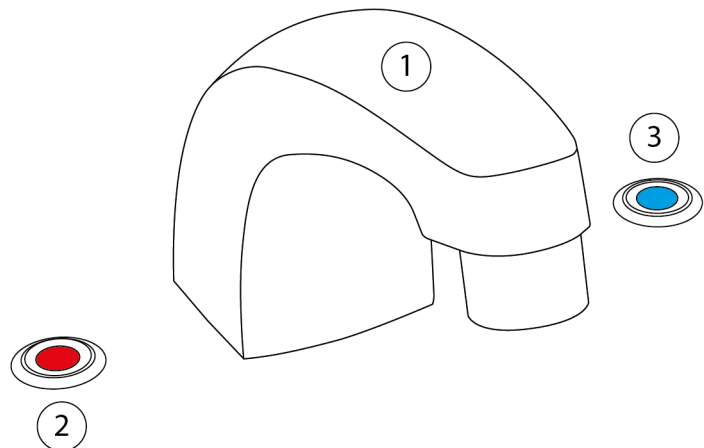

Cold Water

3. To reduce the temperature of the water, press the cold (blue) button (3). The water flow can be stopped at any time by pressing the button again. Do not leave the bath unattended if the button is pressed a second time. Check the water temperature with a thermometer.

Fig 0246

Tamperproof Lockout

4. The 'Autofill' has a lock out to prevent wastage of water and tampering: To Lock: Press and hold down both the hot (red) button (2) and the cold blue button (3) for 10 seconds. The buttons will turn green confirming water lock out.
5. To Unlock: Press and hold down both the hot (red) button (2) and the cold blue button (3) for 10 seconds again. The buttons will turn red and blue confirming unlock.

TWIN LEVER BATH FILLER OPTION



NOTE: The twin lever bath filler option has a pre-set temperature of 43° degrees Celsius.

The twin lever bath filler option is very simple to operate as follows:

1. The mixer spout (1) sits between the two taps.
2. To open the cold tap, turn the handle (2), anticlockwise. To close the cold tap, turn the handle (2), clockwise.
3. To open the hot tap, turn the handle (3), clockwise. To close the hot tap, turn the handle (3), anticlockwise.

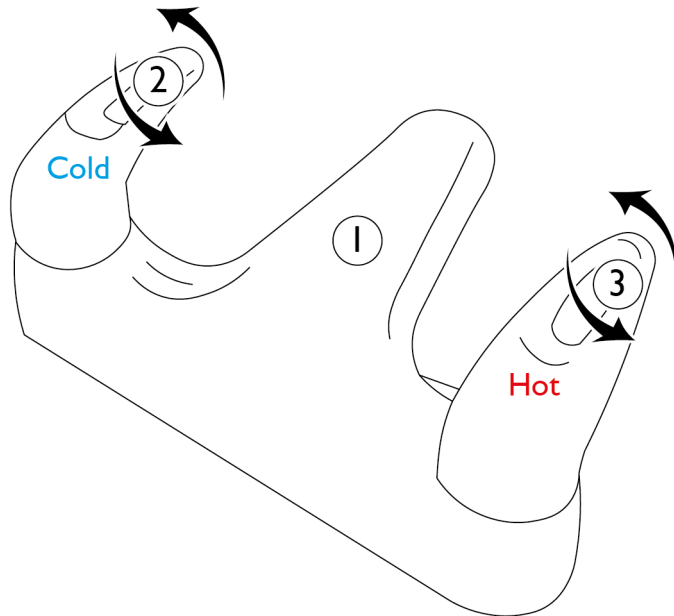

Fig 0274

SCHUCHMANN BASTI SEAT OPTION

The 'Schuchmann Basti Seat' is a seat that can be mounted onto the bath platform and is intended for smaller bathers up to 45Kg. There are two different size 'Schuchmann Basti Seats' available. It has a cover with a hollow for the pelvis giving added comfort, an additional retainer strap and head guide are also available. The Basti seat must be used in conjunction with a 'Basti Seat Fixing Bracket', please see user/part manual. A 'Schuchmann Basti Seat and Fixing Bracket User/Parts Manual' is available. For additional information contact Abacus Specialist Bathroom Solutions: Tel 01527 400024.

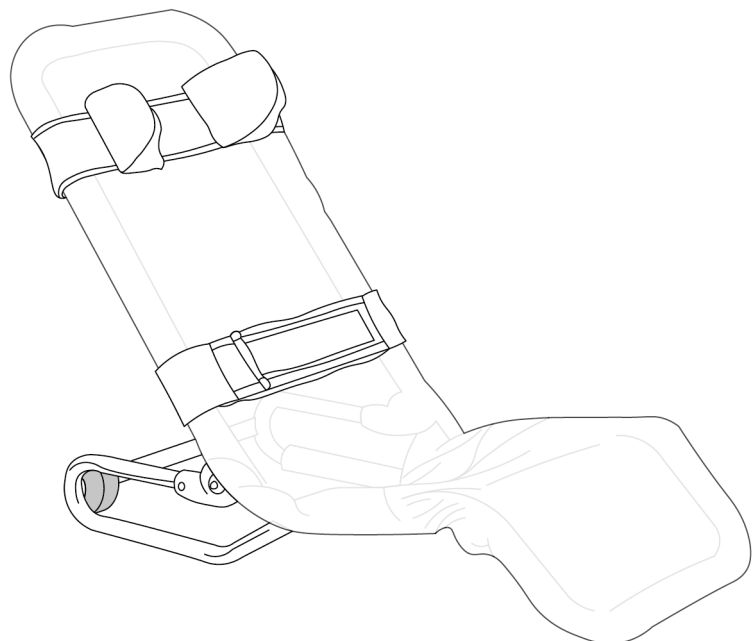

Fig 0275

MISCELLANEOUS OPTIONS

There are a multitude of additional options available to improve the bathers experience, such as cushions, postural supports, safety rail, see [bath and equipment overview, page 5](#). For additional information regarding any optional equipment contact Abacus Specialist Bathroom Solutions:

Tel 01527 400024.

MAINTENANCE AND CLEANING



CAUTION: The bath and any additional equipment could become damaged or wear prematurely if thorough, regular, cleaning and maintenance is not carried out. Contact bath supplier for clarification or additional assistance if required.



NOTE: Ensure your bath is cleaned, serviced and maintained regularly. Maintenance and cleaning information is provided for maintenance staff employed to look after the bath equipment supplied.



Contact: Please ask for details of the of **Gainsborough Healthcare Group Ltd.** Service and Maintenance Agreement on 01527 400022.

During cleaning and any maintenance procedures it is of the utmost importance to follow the 'Health and Safety Information' see [safety information, page 11](#) section, before carrying out any cleaning or maintenance procedures. The following routines are a minimum requirement, where a high volume of use occurs increase the frequency as appropriate.

In addition to the maintenance and cleaning requirements detailed here, it is the responsibility of the equipment operator/provider, under the Provision and Use of Work Equipment Regulations 1998 (PUWER) to ensure, where applicable, that periodic Lifting Operations and Lifting Equipment Regulations (LOLER) testing is undertaken.

DAILY

Routine	Method
Minor clean (after use)	<ul style="list-style-type: none"> Wipe bath whilst draining with a soft damp cloth, clean with disinfectant and wipe dry

WEEKLY

Routine	Method
Major clean (after use)	<ul style="list-style-type: none"> Use cleaning mousse/washing-up liquid/warm water and a soft cloth - stubborn stains may require a non-abrasive cream cleaner Clean with disinfectant and wipe dry
Inspect handset/cable	<ul style="list-style-type: none"> Inspect handset and cable for ANY signs of damage
Check water temperature	<ul style="list-style-type: none"> Using a calibrated thermometer operate the hot tap/'Autofill' and check the water temperature it must NOT exceed 43°C
Platform operation	<ul style="list-style-type: none"> Operate platform up and down ensure it operates correctly without obstruction or any undue noise
Platform inspection	<ul style="list-style-type: none"> Raise platform to its maximum height, push on the platform ensure there is NO lateral movement

MONTHLY

Routine	Method
Remove Lyme/Calcium deposits	<ul style="list-style-type: none"> Water stain deposits may be removed using a non-abrasive cream cleaner
Inspect cables	<ul style="list-style-type: none"> Check there are no loose/damaged/frayed cables
Check for leaks	<ul style="list-style-type: none"> Check water, waste pipes. and all plumbing connections for leaks
Check remote handset operation	<ul style="list-style-type: none"> Operate ALL bath controls 'Platform up' 'Platform down' 'Bath up' and 'Bath down' ensure all operations are as expected and free from unusual noises see remote handset, page 19
Test RCD	<ul style="list-style-type: none"> Operate the Residual Circuit Breaker (RCD) press the test button and reset
Inspect Shepherd's Crook shower (option)	<ul style="list-style-type: none"> Ensure the Shepherd's Crook is fixed/secure and vertical, inspect hose, trigger operation hanger and control see shepherd's crook shower option, page 29
Inspect Roaming shower (option)	<ul style="list-style-type: none"> Ensure the Roaming shower is fixed/secure, inspect hose, trigger operation hanger and control see roaming shower option, page 30
Test 'Autofill' (option) functionality	<ul style="list-style-type: none"> Test the 'Autofill' operation and water levels see autofill option, page 31

SIX MONTHLY

Routine	Method
Visual inspection	<ul style="list-style-type: none"> Visually inspect bath ensure there is NO damage
Panel inspection	<ul style="list-style-type: none"> Check all external bath panels are secure with all screws/ fixings in place
Inspect platform fixings and operation	<ul style="list-style-type: none"> Lift the platform see raise the platform, page 27 and lock in place, see lock the platform, page 27 inspect fixings and hinges are secure, lower platform and ensure safety plunger locks the platform securely see lower the platform, page 28
Inspect waste pipes	<ul style="list-style-type: none"> Ensure ALL waste fitting are secure free from leaks and drain efficiently
Inspect all optional safety equipment	<ul style="list-style-type: none"> Inspect any optional safety equipment is free from ANY damage

ANNUALLY

Routine	Method
Servicing	<ul style="list-style-type: none"> Servicing by Gainsborough Healthcare Group Ltd or a trained approved company with guidance

It is of the utmost importance to follow the Health and Safety information (see [safety information, page 11](#)), before carrying out any cleaning or maintenance procedures. The following is a typical schedule for the average user. Where a high volume of use occurs, increase the frequency as appropriate.

Maintenance Schedule Minimum Frequency					
	Day	Week	Month	6 Month	Year
Minor clean (after use)	X				
Major clean (after use)		X			
Inspect handset/cable		X			
Check water temperature		X			
Platform operation		X			
Platform inspection		X			
Remove Lyme/Calcium deposits			X		
Inspect cables			X		
Check for leaks			X		
Check remote handset operation			X		
Test RCD			X		
Inspect Shepherd's Crook shower (option)			X		
Inspect Roaming shower (option)			X		
Test 'Autofill' (option) functionality			X		
Visual inspection				X	
Panel inspection				X	
Inspect platform fixings and operation				X	
Inspect waste pipes				X	
Inspect all optional safety equipment				X	
Servicing					X

TROUBLESHOOTING

The following is a basic troubleshooting guide in the event of failure, it is not intended as a comprehensive diagnostic routine. If the bath or equipment fail to operate as intended following these basis checks, please contact a service support engineer Tel 01527 400024.

PROBLEM	POSSIBLE CAUSE
Bath/Platform Inoperative	<ul style="list-style-type: none">• Mains power supply failure, check handset power supply• Check condition of handset cord and it is securely connected to the bath• Check 5Amp fused spur (fuse)• Check Residual Current Device (RCD) has power and not tripped• Remove platform rods and re-grease with 'Silicone Paste'
Bath Judders	<ul style="list-style-type: none">• Check there are no obstructions on or around the bath• Check bath fixings are secure• Check bath is level• Remove platform rods and re-grease with 'Silicone Paste'
Bath Noisy	<ul style="list-style-type: none">• Check there are no obstructions on or around the bath• Check pipework, cables or anything else is not fouling on any panels or framework during operation• Remove platform rods and re-grease with 'Silicone Paste'
Water Leaking/Loss	<ul style="list-style-type: none">• Visually inspect for bath damage• Inspect flexi-hoses pipework• Inspect hot and cold supply pipework• Inspect waste pipework• Remove platform rods and re-grease with 'Silicone Paste'
Bath Uneven	<ul style="list-style-type: none">• May occur after a power failure. Attempt a reset, operate handset 'Bath down' button then operate 'Platform down' to lowest position then re-test
Bath Beeping	<ul style="list-style-type: none">• Mains power supply failure, check handset power supply
Bath Panels touching/fouling/noisy	<ul style="list-style-type: none">• Inspect remove and refit bath panels to ensure correct fitting and alignment

WARRANTY

For information on the warranty supplied with this bath, please refer to separate warranty documentation.



Contact: Please ask for details of the **Gainsborough Healthcare Group Ltd.** Service and Maintenance Agreement on 01527 400022 or email warranties@ghg-uk.com.

DECLARATION OF CONFORMITY



Gainsborough Healthcare Group
Life enhancing bathing

Declaration of Conformity

Manufacturer's name: Gainsborough Healthcare Group Ltd

Manufacturer's Address: 10 & 11 The Oaks
Clews Road
Redditch
Worcestershire
B98 7ST

Equipment Type: Bath Chassis with Platform

Gainsborough Healthcare Group Ltd solely declares that the below products comply with the essential requirements and fulfil the provision of the CE marking.

Bath Model	UDI	P/N	
Gemini 1700 – Height Adjustable Bath with Platform – Kit Form (Side Feed)	(01)05060968110413	AQK142LW	AQK142RW
Gemini 1700 – Height Adjustable Bath with Platform – (Side Feed)	(01)05060968110413	AQ142LW	AQ142RW
Gemini 1700 – Height Adjustable Bath with Platform – Peninsula – Kit Form (End Feed)	(01)05060968110413	AQK142LWP	AQK142RWP
Gemini 1700 – Height Adjustable Bath with Platform – Peninsula (End Feed)	(01)05060968110413	AQ142LWP	AQ142RWP
Gemini 1700 – Height Adjustable Bath with Platform – Kit Form (Floor Feed)	(01)05060968110413	AQK142LWF	AQK142RWF
Gemini 1700 – Height Adjustable Bath with Platform (Floor Feed)	(01)05060968110413	AQ142LWF	AQ142RWF
Gemini 2000 Height adjustable bath with platform DLWP - Kit Form (side feed)	(01)05060968110550	AGWK20L	AGWK20R
Gemini 2000 Height adjustable bath with platform DLWP (side feed)	(01)05060968110550	AGW20L	AGW20R
Gemini 2000 Height adjustable bath with platform DLWP Peninsula - Kit Form (end feed)	(01)05060968110550	AGWK20LP	AGWK20RP
Gemini 2000 Height adjustable bath with platform DLWP Peninsula (end feed)	(01)05060968110550	AGW20LP	AGW20RP
Trade Names	UDI	P/N	
GSB Bio Oraya 1700 Height Adjustable Bath with platform (side feed)	(01)05060968110239	BORAW7L	BORAW7R
GSB Bio Oraya 1700 Height Adjustable Bath with platform (end feed)	(01)05060968110239	BORAW7LP	BORAW7RP
GSB Bio Oraya 1700 Height Adjustable Bath with platform (floor feed)	(01)05060968110239	BORAW7LF	BORAW7RF

The products correspond to Class I Medical Device Directive.

The following standards and European Directives apply:

- 2006/42/EC Machinery Directive
- MDR 2017-745/EU – Class I Medical Device
- ROHS – Restriction of Hazardous Substances
- IEC 60601
- BS EN 60601-01-11 – General requirements for basic health and safety and essential performance – Home healthcare environment
- BS EN 60601-1-6 – General requirements for basic safety and essential performance
- BS EN 62366-1 – Application of usability engineering to medical devices
- BS EN ISO 10535:2021 – Assistive products – Hoists for the transfer of persons – Requirements and test methods
- BS EN ISO 10993-1 – 2022 – Biological Evaluation of medical devices
- BS EN ISO 21856-2022 – Assistive products – General requirements and test methods

Peter Eckhardt
C.E.O

For and on behalf of Gainsborough Healthcare Group Ltd

Date of issue; 15/12/2021



Gainsborough Healthcare Group
Life enhancing bathing.

Declaration of Conformity

Manufacturer's name: Gainsborough Healthcare Group Ltd
Manufacturer's Address: 10 & 11 The Oaks

Clews Road
Redditch
Worcestershire
B98 7ST

Equipment Type: Bath Chassis with Platform

Gainsborough Healthcare Group Ltd solely declares that the below products comply with the essential requirements and fulfil the provision of the UKCA marking.

Bath Model	UDI	P/N	
Gemini 1700 – Height Adjustable Bath with Platform – Kit Form (Side Feed)	(01)05060968110413	AQK142LW	AQK142RW
Gemini 1700 – Height Adjustable Bath with Platform – (Side Feed)	(01)05060968110413	AQ142LW	AQ142RW
Gemini 1700 – Height Adjustable Bath with Platform – Peninsula – Kit Form (End Feed)	(01)05060968110413	AQK142LWP	AQK142RWP
Gemini 1700 – Height Adjustable Bath with Platform – Peninsula (End Feed)	(01)05060968110413	AQ142LWP	AQ142RWP
Gemini 1700 – Height Adjustable Bath with Platform – Kit Form (Floor Feed)	(01)05060968110413	AQK142LWF	AQK142RWF
Gemini 1700 – Height Adjustable Bath with Platform (Floor Feed)	(01)05060968110413	AQ142LWF	AQ142RWF
Gemini 2000 Height adjustable bath with platform DLWP - Kit Form (side feed)	(01)05060968110550	AGWK20L	AGWK20R
Gemini 2000 Height adjustable bath with platform DLWP (side feed)	(01)05060968110550	AGW20L	AGW20R
Gemini 2000 Height adjustable bath with platform DLWP Peninsula - Kit Form (end feed)	(01)05060968110550	AGWK20LP	AGWK20RP
Gemini 2000 Height adjustable bath with platform DLWP Peninsula (end feed)	(01)05060968110550	AGW20LP	AGW20RP
Trade Names	UDI	P/N	
GSB Bio Oraya 1700 Height Adjustable Bath with platform (side feed)	(01)05060968110239	BORAW7L	BORAW7R
GSB Bio Oraya 1700 Height Adjustable Bath with platform (end feed)	(01)05060968110239	BORAW7LP	BORAW7RP
GSB Bio Oraya 1700 Height Adjustable Bath with platform (floor feed)	(01)05060968110239	BORAW7LF	BORAW7RF

The products correspond to Class I Medical Device Directive.

The following standards and European Directives apply:

- 2006/42/EC Machinery Directive
- MDR 2017-745/EU – Class I Medical Device
- ROHS – Restriction of Hazardous Substances
- IEC 60601
- BS EN 60601-01-11 – General requirements for basic health and safety and essential performance – Home healthcare environment
- BS EN 60601-1-6 – General requirements for basic safety and essential performance
- BS EN 62366-1 – Application of usability engineering to medical devices
- BS EN ISO 10535:2021 – Assistive products – Hoists for the transfer of persons – Requirements and test methods
- BS EN ISO 10993-1 – 2022 – Biological Evaluation of medical devices
- BS EN ISO 21856-2022 – Assistive products – General requirements and test methods

Peter Eckhardt
C.E.O

For and on behalf of Gainsborough Healthcare Group Ltd

Date of issue: 15/12/2021

Registered in England No. 10433373 | VAT No. 254046128

Gainsborough Healthcare Group

Life enhancing bathing



ABACUS
SPECIALIST BATHROOM SOLUTIONS

Abacus Healthcare part of GAINSBOROUGH HEALTHCARE GROUP LTD
10 & 11 Clews Road, Redditch, Worcestershire B98 7ST
Tel: 01527 400024 Email: info@abacushealthcare.co.uk
www.abacushealthcare.co.uk